





CVM SERIES

VIBRATOR MOTOR

Innovation, Quality, Credit, Gold Brand
Confidence From Brand Concept, Creating A World-famous Enterprise

-  Environmental
-  Quality
-  Efficient
-  Technology

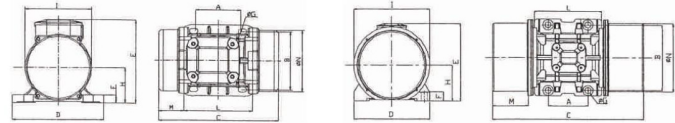

2 POLES-3000rpm

Type	Vibrating Force kg	Power(KW)	Efficiency(%)	Current(A)	Weight(kg)	Size
CVM-60/3	71	0.7	0.08	46	0.16	5.6 10
CVM-100/3	99	1	0.1	44	0.19	5.9 10
CVM-200/3	198	2	0.17	60	0.35	7.0 10
CVM-300/3	311	3	0.2	64	0.52	10.4 20
CVM-400/3	400	4	0.2	74	0.58	10.8 20
CVM-500/3	516	5	0.45	77	0.96	18.8 30
CVM-700/3	750	7	0.5	77	1.25	20 30
CVM-800/3	788	8	0.55	79	1.45	21.5 30
CVM-1200/3	1018	10	0.75	82	1.85	22.5 30
CVM-1300/3	1386	13	1.1	76	2.44	24.5 30
CVM-1600/3	1571	16	1.25	81	2.94	51.6 40
CVM-1800/3	1848	18	1.5	81	3.75	52 40
CVM-2000/3	2033	20	2	83	4.07	51.8 40
CVM-2300/3	2310	23	2	83	4.44	53.6 40
CVM-3200/3	3250	32	2.2	76	5.3	96.9 50
CVM-4000/3	4030	40	2.3	76	5.3	107 50
CVM-5000/3	5070	50	3.5	83	7.22	111.2 50

2 POLES-3000rpm

Type	A	B	C	D	E	F	ΦG	H	I	L	M	N	Cable Gland	Fig
CVM-60/3	62-74	106	231	131	159	15	9	64	121	123	54	112	M20x1.5	A
CVM-100/3	62-74	106	231	131	159	15	9	64	121	123	54	112	M20x1.5	A
CVM-200/3	62-74	106	231	131	159	15	9	64	121	123	54	112	M20x1.5	A
CVM-300/3	90	125	273	155	175	15	13	79	142	163	55	131	M20x1.5	B
CVM-400/3	90	125	273	155	175	15	13	79	142	163	55	131	M20x1.5	B
CVM-500/3	120	170	362	208	210	22	17	94	180	205	78	170	M20x1.5	B
CVM-700/3	120	170	362	208	210	22	17	94	180	205	78	170	M20x1.5	B
CVM-800/3	120	170	362	208	210	22	17	94	180	205	78	170	M20x1.5	B
CVM-1200/3	120	170	362	208	210	22	17	94	180	205	78	170	M20x1.5	B
CVM-1300/3	120	170	362	208	210	22	17	94	180	205	78	170	M20x1.5	B
CVM-1600/3	140	190	421	229	262	30	17	120	247	225	80	222	M25x1.5	B
CVM-1800/3	140	190	421	229	262	30	17	120	247	225	80	222	M25x1.5	B
CVM-2000/3	140	190	421	229	262	30	17	120	247	225	80	222	M25x1.5	B
CVM-2300/3	140	190	421	229	262	30	17	120	247	225	80	222	M25x1.5	B
CVM-3200/3	155	255	553	302	318	35	25	147	295	288	115	264	M32x1.5	B
CVM-4000/3	155	255	553	302	318	35	25	147	295	288	115	264	M32x1.5	B
CVM-5000/3	155	255	553	302	318	35	25	147	295	288	140	264	M32x1.5	B

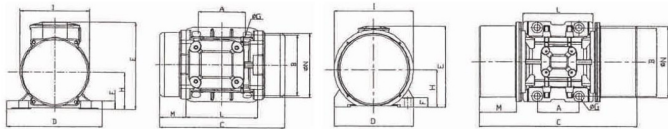

4 POLES-1500 rpm

Type	Vibrating Force kg	Power(kW)	Efficiency(%)	Current(A)	Weight(kg)	Size	
CVM-40/4	40	0.4	0.03	33	0.26	5.9	10
CVM-80/4	80	0.8	0.04	36	0.31	7.4	10
CVM-200/4	183	2	0.06	50	0.49	11.8	20
CVM-400/4	388	4	0.3	60	0.84	23.5	30
CVM-500/4	518	5	0.37	68	1.06	24.2	30
CVM-700/4	693	7	0.55	77	1.32	27.4	30
CVM-800/4	807	8	0.6	73	1.36	28.3	30
CVM-1100/4	1045	11	0.6	73	1.4	35.8	30
CVM-1400/4	1406	14	0.85	75	1.78	59.8	40
CVM-1700/4	1757	17	1.1	68	2.09	68.8	40
CVM-2400/4	2420	24	1.3	71	3.2	79	40
CVM-3000/4	3065	30	2.3	79	3.68	125	50
CVM-3800/4	3830	38	2.3	78	4.15	130.4	50
CVM-4300/4	4312	43	2.6	78	4.5	134.4	50
CVM-5500/4	5576	55	2.3	73	6.5	192.2	60
CVM-7200/4	7188	72	3	75	9.6	253	70
CVM-9000/4	8984	90	5.8	83	13.4	268.6	70
CVM-10000/4	10052	100	6.3	82	14.4	311.8	80

4 POLES-1500 rpm

Type	A	B	C	D	E	F	ΦG	H	I	L	M	N	Cable Gland	Fig
CVM-40/4	62-74	106	221	130	136	12	9	48	94	121	54	86	M16x1.5	A
CVM-80/4	62-74	106	231	131	159	15	9	64	121	123	54	112	M20x1.5	A
CVM-200/4	90	125	273	154	175	15	13	79	142	163	55	131	M20x1.5	B
CVM-400/4	120	170	362	208	210	22	17	94	180	205	78	170	M20x1.5	B
CVM-500/4	120	170	362	208	210	22	17	94	180	205	78	170	M20x1.5	B
CVM-700/4	120	170	362	208	210	22	17	94	180	205	78	170	M20x1.5	B
CVM-800/4	120	170	362	208	210	22	17	94	180	205	78	170	M20x1.5	B
CVM-1100/4	120	170	451	208	210	22	17	94	180	205	123	170	M20x1.5	B
CVM-1400/4	140	190	453	229	262	30	17	120	247	225	96	222	M25x1.5	B
CVM-1700/4	140	190	453	229	262	30	17	120	247	225	96	222	M25x1.5	B
CVM-2400/4	140	190	519	229	262	30	17	120	247	225	129	222	M25x1.5	B
CVM-3000/4	155	255	603	302	318	35	23.5	147	295	288	140	264	M32x1.5	B
CVM-3800/4	155	255	603	302	318	35	23.5	147	295	288	140	264	M32x1.5	B
CVM-4300/4	155	255	603	302	318	35	23.5	147	295	288	140	264	M32x1.5	B
CVM-5500/4	180	280	603	332	360	37	26	168	345	304	130	310	M32x1.5	B
CVM-7200/4	200	320	608	378	411	49	28	200	424	325	120	378	M32x1.5	B
CVM-9000/4	200	320	608	378	411	49	28	200	424	325	120	378	M32x1.5	B
CVM-10000/4	125	380	726	452	430	44	39	204	422	367	160	378	M32x1.5	C

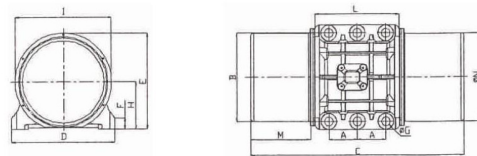

6 POLES-1000rpm

Type	Vibrating Force kg	Power(kW)	Efficiency(%)	Current(A)	Weight(kg)	Size	
CVM-50/6	51	0.5	0.03	25	0.38	10.4	20
CVM-200/6	185	1.8	0.15	58	0.63	19.6	30
CVM-300/6	308	3	0.2	64	0.74	26.6	30
CVM-400/6	408	4	0.25	68	0.82	30.5	30
CVM-500/6	510	5	0.37	67	1.22	34	30
CVM-800/6	781	7.8	0.5	66	1.26	61.8	40
CVM-1100/6	1067	11	0.55	68	1.42	79.4	40
CVM-1400/6	1378	14	0.7	68	1.95	81.7	40
CVM-1500/6	1500	15	0.7	68	2	83.6	40
CVM-1600/6	1600	16	0.75	73	2.06	85.4	40
CVM-2100/6	2026	21	1.1	73	2.88	114.3	50
CVM-2500/6	2573	25	1.5	77	3.63	148.6	50
CVM-3000/6	2931	30	1.7	77	4.17	155.4	50
CVM-3800/6	3835	38	2	80	4.67	215.6	60
CVM-4700/6	4721	47	2.35	81	6.01	230.8	60
CVM-5200/6	5193	52	2.6	81	6.92	279.8	70
CVM-6500/6	6491	65	2.9	81	7.76	304.4	70
CVM-8000/6	8018	80	4.5	82	12.6	325.2	70
CVM-9000/6	8936	90	5	81	13.2	337.8	70
CVM-10000/6	10170	100	6.2	83	14.3	385.8	80
CVM-13000/6	12700	130	7	84	16	422.2	80

6 POLES-1000rpm

Type	A	B	C	D	E	F	ΦG	H	I	L	M	N	Cable Gland	Fig
CVM-50/6	90	125	273	154	175	15	13	79	142	163	55	131	M20x1.5	B
CVM-200/6	120	170	362	208	210	22	17	94	180	205	78	170	M20x1.5	B
CVM-300/6	120	170	362	208	210	22	17	94	180	205	78	170	M20x1.5	B
CVM-400/6	120	170	451	208	210	22	17	94	180	205	123	170	M20x1.5	B
CVM-500/6	120	170	451	208	210	22	17	94	180	205	123	170	M20x1.5	B
CVM-800/6	140	190	453	229	262	30	17	120	247	225	96	222	M25x1.5	B
CVM-1100/6	140	190	519	229	262	30	17	120	247	225	129	222	M25x1.5	B
CVM-1400/6	140	190	567	229	262	30	17	120	247	225	154	222	M25x1.5	B
CVM-1500/6	140	190	567	229	262	30	17	120	247	225	154	222	M25x1.5	B
CVM-1600/6	140	190	567	229	262	30	17	120	247	225	154	222	M25x1.5	B
CVM-2100/6	155	255	603	302	318	35	23.5	147	295	288	140	264	M32x1.5	B
CVM-2500/6	155	255	723	302	318	35	23.5	147	295	288	200	264	M32x1.5	B
CVM-3000/6	155	255	723	302	318	35	23.5	147	295	288	200	264	M32x1.5	B
CVM-3800/6	180	280	683	332	360	37	26	168	345	304	170	310	M32x1.5	B
CVM-4700/6	180	280	733	332	360	37	26	168	345	304	195	310	M32x1.5	B
CVM-5200/6	200	320	688	378	411	49	28	200	424	325	160	378	M32x1.5	B
CVM-6500/6	200	320	688	378	411	49	28	200	424	325	160	378	M32x1.5	B
CVM-8000/6	200	320	788	378	411	49	28	200	424	325	210	378	M32x1.5	B
CVM-9000/6	200	320	788	378	411	49	28	200	424	325	210	378	M32x1.5	B
CVM-10000/6	125	380	826	452	430	44	39	204	422	367	210	378	M32x1.5	C
CVM-13000/6	125	380	926	452	430	44	39	204	422	367	260	378	M32x1.5	C



2 POLES SINGLE-PHASE-3000 rpm

Type	Vibrating Force kg	kn	Frequency (r/min)	Power(kW)	Current(A)	Weight(kg)	Capacitor(μF)	Size
CVM-20S	20	0.2	3000	0.02	0.1	1.5	1.5	5
CVM-60S	66	0.7	3000	0.08	0.43	5.7	4	10
CVM-100S	99	1	3000	0.1	0.54	5.9	5	10
CVM-200S	197	2	3000	0.13	0.71	6.8	5	10
CVM-300S	311	3	3000	0.29	1.58	10	12	20
CVM-400S	400	4	3000	0.31	1.68	10.8	12	20

Type	A	B	C	D	E	F	ΦG	H	I	L	M	N	Cable Gland	Fig
CVM-20S	28-40	94	152	111	85	9	7.5	33	50	84	34	60	M16x1.5	A
CVM-60S	62-74	106	231	130	159	15	9	64	120	123	54	112	M20x1.5	A
CVM-100S	62-74	106	231	130	159	15	9	64	120	123	54	112	M20x1.5	A
CVM-200S	62-74	106	231	130	159	15	9	64	120	123	54	112	M20x1.5	A
CVM-300S	90	125	275	155	177	14	13	79	142	163	55	132	M20x1.5	A
CVM-400S	90	125	275	155	177	14	13	79	142	163	55	132	M20x1.5	A

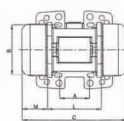
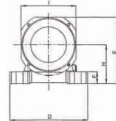
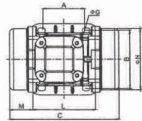
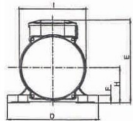

A

E

DC DIRECT CURRENT-3000 rpm

Type	Volt (V)	Vibrating Force kg	kn	Frequency (r/min)	Power(kW)	Current(A)	Weight(kg)	Size
CVM-50DC-24	24	50	0.5	3000	0.1	4.2	6	10
CVM-50DC-12	12	50	0.5	3000	0.1	9.4	6	10
CVM-200DC-24	24	200	2	3000	0.16	6.67	6.5	30
CVM-200DC-12	12	200	2	3000	0.16	13.3	6.5	30

Type	A	B	C	D	E	F	ΦG	H	I	L	M	N	Cable Gland	Fig
CVM-50DC-24	62-74	106	231	130	159	15	9	64	120	123	54	112	M20x1.5	A
CVM-50DC-12	62-74	106	231	130	159	15	9	64	120	123	54	112	M20x1.5	A
CVM-200DC-24	62-74	106	218	164	140	25	9	82	116	123	53	110	M20x1.5	E
CVM-200DC-12	62-74	106	218	164	140	25	9	82	116	123	53	110	M20x1.5	E

CVM SERIES Vibrator Motor

Innovation, Quality, Credit, Gold Brand

Confidence From Brand Concept, Creating A World-famous Enterprise



Environmental



Quality



Efficient



Technology

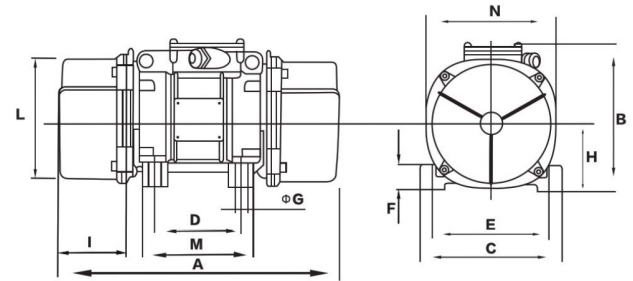

CVM SERIES DIMENSIONAL FEATURES

Frame No	A	B	C	D	E	F	G	H	I	L	M	N
001	230	150	150	110	120	13	11	79	43	124	137	153
002	275	176	170	110	120	13	13	92	72	150	140	140
003	360	188	200	110	140	13	13	98	90	165	160	155
004	420	216	225	140	170	15	15	104	90	195	160	155
005	490	285	209	160	200	25	14	130	213	213	255	155